

2011

Town of Union "Mini Newsletter" Winter 2011

Union (Me.)

Follow this and additional works at: <https://digitalcommons.library.umaine.edu/towndocs>

Repository Citation

Union (Me.), "Town of Union "Mini Newsletter" Winter 2011" (2011). *Maine Town Documents*. 854.
<https://digitalcommons.library.umaine.edu/towndocs/854>

This Newsletter is brought to you for free and open access by DigitalCommons@UMaine. It has been accepted for inclusion in Maine Town Documents by an authorized administrator of DigitalCommons@UMaine. For more information, please contact um.library.technical.services@maine.edu.

TOWN OF UNION

WINTER 2011

<http://www.union.govoffice2.com/>

785-3658

JANUARY 4, 2011

- INFORMATIONAL MEETING
- SCHOOL BUDGETS NOW BEING FORMED
- SNOWSTORMS, MAILBOXES ETC
- NEW BUILDING CODES COMING SOON
- TRANSFER STATION NEWS



Questions, concerns? Please contact the Town Manager anytime either by mail or phone!
jayunion@roadrunner.com
785-3658

UPCOMING INFORMATIONAL MEETING FEBRUARY 1ST SCHOOL BUDGET

Last year I requested the Board of Selectmen consider a "informational meeting" where taxpayers can come and ask questions to Department Heads, Selectmen and the Town Manager.

Late in January we had close to 70 people attend and much discussion was had on roads, budgets and more.

During formal Town Meetings you are not able to get some information as it is a formal meeting with formal rules. But during our informational meetings you are free to get details

But if you want information on how we prepare our budgets, procedures and policies, this is the time to ask!

We are just starting our budget process and now is the time for your input.

6:30 the meeting promptly begins and will end by 8:00 pm!

Bring a refreshment (baked goods) and we will supply coffee and juice

" LOCAL GOVERNMENT BEGINS WITH YOU"

As we speak SAD # 40 is beginning to form the budget for 2011-2012.

The school budget is the major part of the taxes you pay each year. Whatever your opinion is on this budget it is imperative that you show an interest by attending some of the budget sessions.

Go to the SAD 40 website and dates and times will be listed.

You may not think your opinion counts but it does!

SNOWSTORMS, MAILBOXES, SAND AND MORE

As of this writing we have two storms that have been very expensive. Both have lasted over 24 hours with the latest blizzard going 30 plus hours for our crew.

Storm 1: Our first storm was not major in snow total but it snowed for a significant amount of time and that coupled with two major truck

breakdowns made life at PW a bit tough to say the least. At one point we were down to one truck.

Storm 2: Everyone got an extra day off for the Christmas break with this one, except the PW department.

PW started plowing at 7PM Sunday night, and was on the road until 8PM the

following day, at which time the winds were at blizzard conditions and I sent the crew to bed for 5 hours. They were up at 2 and 3 am to start over again. I commend them on a job well done considering we are still down one truck.

Continued on back

DID YOU KNOW?

1. You can get your hunting and fishing licenses, as well as re-register your vehicles online. Go to the Town's web page and follow the links.
2. Heating assistance is available for low to moderate income families, call Penquis in Rockland at 800-215-4942.
3. The ambulance service offers free blood pressure checks during regular business hours.
4. We have openings on our Appeals Board.
5. The Town of Union has over 60 miles of roads to plow, that is 120 lane miles!

NEW BUILDING CODES COMING SOON

The State of Maine has adopted the Maine Uniform Building & Energy Code (MUBEC). Local codes that conflict with MUBEC are now void.

Due to the fact that the Town of Union had not formally adopted building code we do not have to enforce the new code until July 1, 2012. However under the law you are still required to use the new codes when you are building.

I urge you to contact our CEO with any questions re-

garding this code.

It is possible with lots of public back-lash some of this may be repealed before 2012 but I think you can rest assured that much of it will stay intact.

The Town will continue to monitor this situation before we begin to spend funds on training or hiring a certified MUBEC inspector.

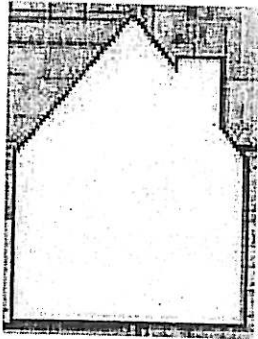

TRANSFER STATION

The transfer station is not run by the Town of Union, it is run by the Tri-County Board.

1. The station has reduced its budget the past two years!
2. The station will be taking bulky plastics and most other plastics; see attendant.
3. Phone is 785-2261

NEW TOWN HOURS BECOME PERMANENT

Back in April we experimented with new hours here at the Town Office.

We experimented with 8-4 hours this summer and had a great response from the citizens for the new hours. So the Board voted to keep these hours permanently.

So Monday thru Thursday we are open from 8:00 am to 4:00 pm., and Friday from 8:00 am to Noon. This keeps

the total hours the same each week but makes it a bit easier for citizens to get here in the morning. In addition on the first and third Tuesday we are open until 6:00 PM!

If you need to re-register a vehicle and we are closed you can do this online 24-7, simply go to the Town's website and follow the "rapid renewal" link. I have put the web address here but the easiest way is to Google the Town of

Union Maine and follow the link from there.

www.union.govoffice2.com/



BURN PERMITS AVAILABLE 5AM TO 5PM 7 DAYS A WEEK AT THE FIRE STATION

SNOWSTORMS, MAILBOXES, SAND AND MORE! (CONTINUED FROM PG 1)

However when it becomes dangerous to the drivers we will pull the trucks off the road except for emergency calls.

MAILBOXES: Yikes, we hit your mailbox! It is inevitable during severe storms that some mailboxes will come off. If a driver hits a box and is aware of it, he will pick it up and place it in a safe spot.

Many times boxes come dislodged not because it was hit, but as in the Xmas storm because the snow pushes it off the stand.

Do we repair boxes? Unfortunately no, all boxes are placed in the Town's right of way, also under Maine law it is illegal for the Town to spend funds for private individuals.

Having said that, if you have lost your post we do have a few steel posts

on rims that you can get from the Town garage after the storm is over.

SAND AND SALT: Sand and salt located at the Public Works garage is not for private use. (same law applies). Also it is very dangerous for anyone to be in or near the sand shed with a bucket or shovel. The mound of sand can fall without notice.



DID YOU LICENSE YOUR DOG YET?